

IN-CLASS 3PT PROBLEM

Key

LAND SURFACE

ELEVATIONS

GRADIENT = $26^\circ = 49\%$
TO POINT

- ① Find MAX. ELEV.
- ② Find MIN. ELEV.
- ③ Draw LINE
- ④ Measure MAP DISTANCE BETWEEN POINTS
- ⑤ Determine RELIEF
- ⑥ Set SCALE POINT MAP UNIT
- ⑦ Determine M.I.D.-LINE POSITION OF 3-PT. ELEVATIONS
- ⑧ Calculate SLOPE or GRADIENT

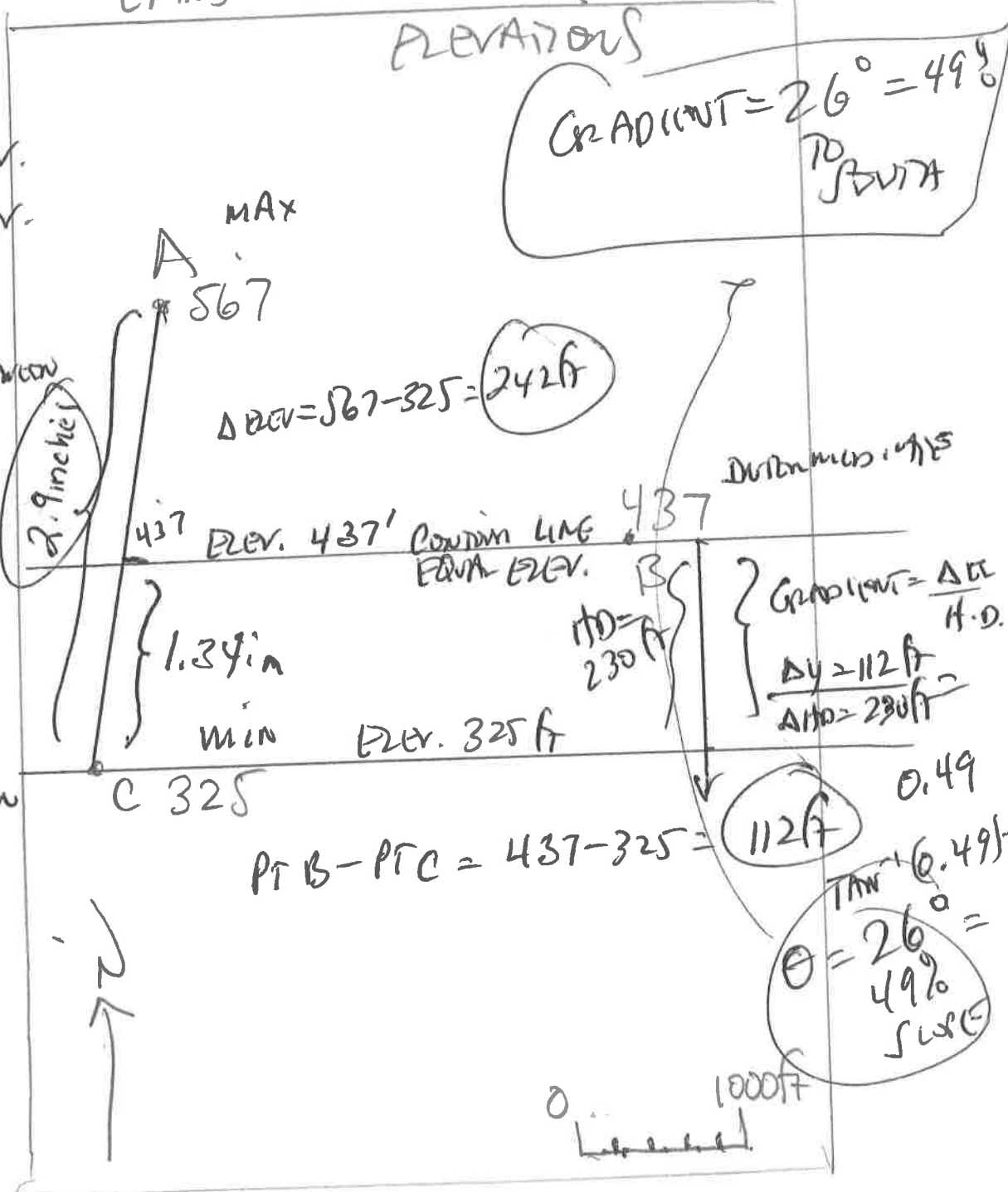

$$\frac{242 \text{ ft}}{2.9 \text{ in}}$$

$$AC \left(\frac{2.9 \text{ in}}{242 \text{ ft}} \right) 112 \text{ ft } BC = 1.34 \text{ in TO POINT OF PT. C ALONG LINE AC}$$